

Graves Park – Ancient Barrow



Tony Spillane
29th July 2019

 alamy stock photo

PY1AX8
www.alamy.com

Graves Park Barrow

- The Graves Park Barrow has been measured, including the six post holes
- The Barrow itself is approximately 15m diameter
- There is a slight ridge surrounding the barrow, which is 33 – 36m diameter (similar to cover photo – from the internet)
- The six post holes appear to be a smaller triangle inside a larger triangle, with a north / south orientation (see scale diagram attached)
- The post holes have a hole diameter of approximately 25cm dia.
- The path over the Barrow has an orientation of approximately 60 deg West of North.

Graves Park Barrow

GRAVES PARK BARROW - LOCATION OF SIX POST HOLES

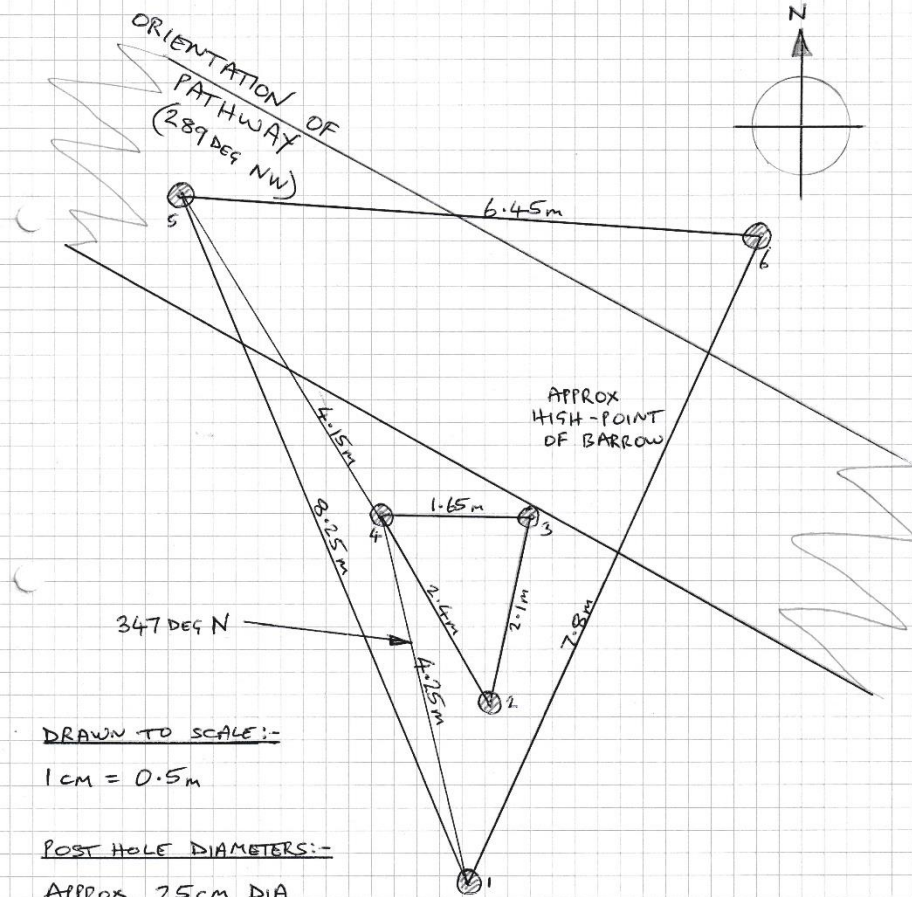

DRAWN TO SCALE:-

1cm = 0.5m

POST HOLE DIAMETERS:-

APPROX 25cm DIA

STONE/CONCRETE SURROUNDS

TONY SPILLANE
29TH JULY 2019

Graves Park Barrow – Post Hole Photos

